

Note:  
 No dimensions on this drawing are to be scaled.  
 All levels and dimensions on this drawing are to be checked on site. Any discrepancies on this drawing are to be reported to and verified with the architect.  
 This drawing is to be read in conjunction with all other application documentation and information as issued.  
 This is not a construction drawing, it is unsuitable for the purpose of construction and must on no account be used as such.  
 This drawing is the copyright of Buchholz McEvoy Architects Ltd and may not be copied, altered, or reproduced in any form or passed to a third party without license or written consent.  
 All extracts from ordnance survey tile ref: 3263-11, 3263-16  
 Copyright: Ordnance Survey Ireland

- Occupancy:
- STUDIO
  - 1 BED
  - 2 BED
  - 3 BED

- R1 Roof type 1 – Flat Roof
  - R2 Roof type 2 – Extensive green roof system
  - R3 Roof type 3 – Intensive green / blue roof system with terrace
  - R4 Roof type 4 – Intensive green roof system
  - R5 Roof type 5 – Intensive green roof system with PV Panels over
  - R6 Roof type 6 – Roof Deck / Terrace
  - R7 Roof type 7 – Roof Terrace
- Please refer to Roof Plan 0318-C-A2-07 for parapet levels and complete key to all elevation/section drawings

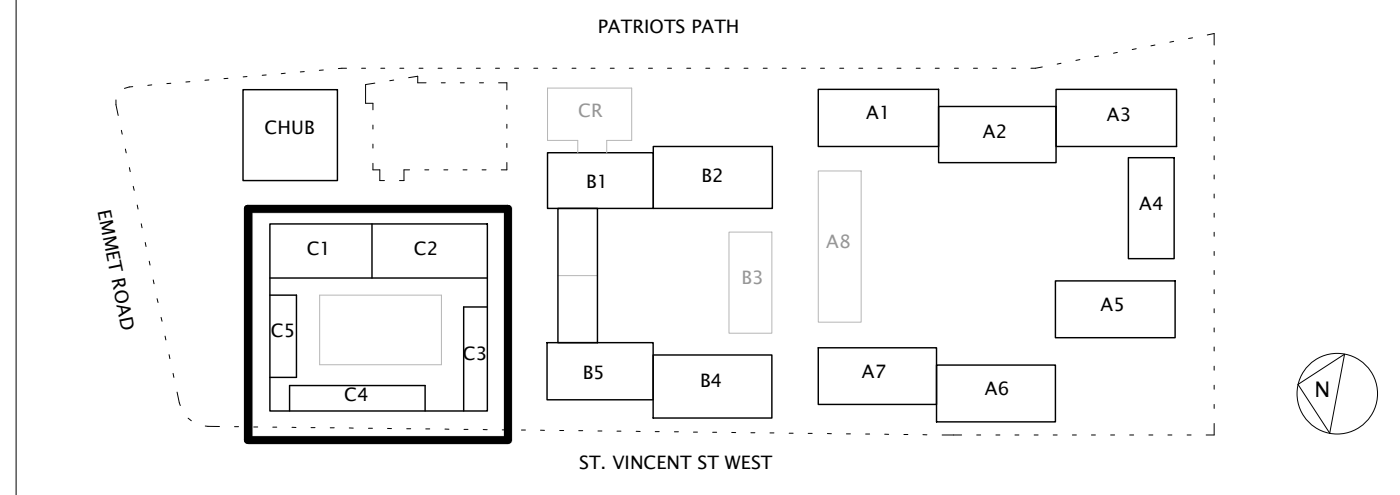

PLANNING		
revision	date	no.

drawing  
**BLOCK C – COMMERCIAL MIXED USE – ROOF PLAN**

drawing no. <b>0318-C-A2-07</b>	scale 1 : 200 @ A1	drawn SJ/MA	project no. <b>0318</b>
	date SEPT 2022	checked KH	revision

project  
**EMMET ROAD MIXED-USE DEVELOPMENT, DUBLIN 8**

client  
**DUBLIN CITY COUNCIL**